

WATERWASH  
MANIFOLDS,  
(OPTIONAL)

8 X 1000 CFM UAPC  
PRECIPITATOR CELLS

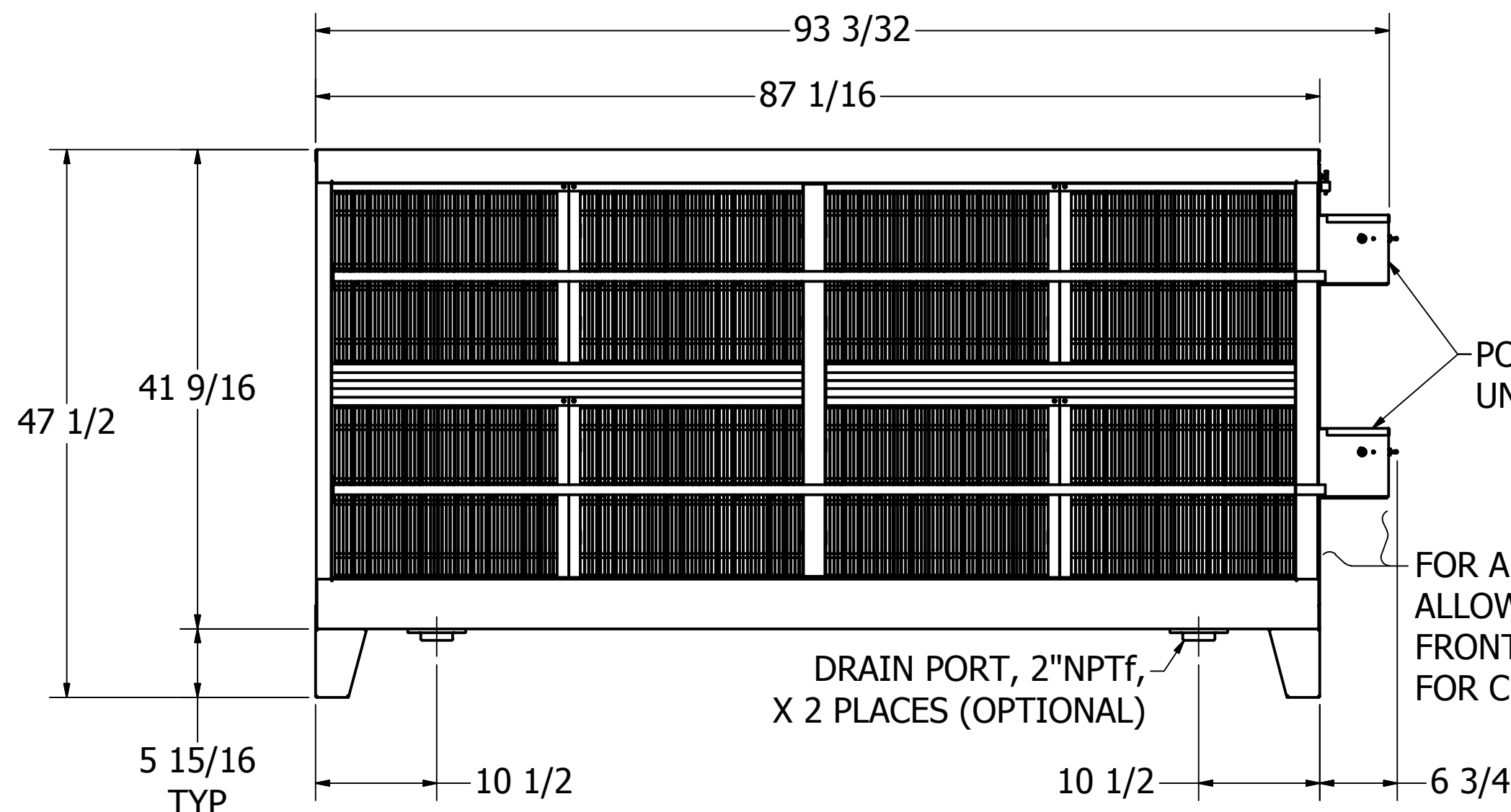
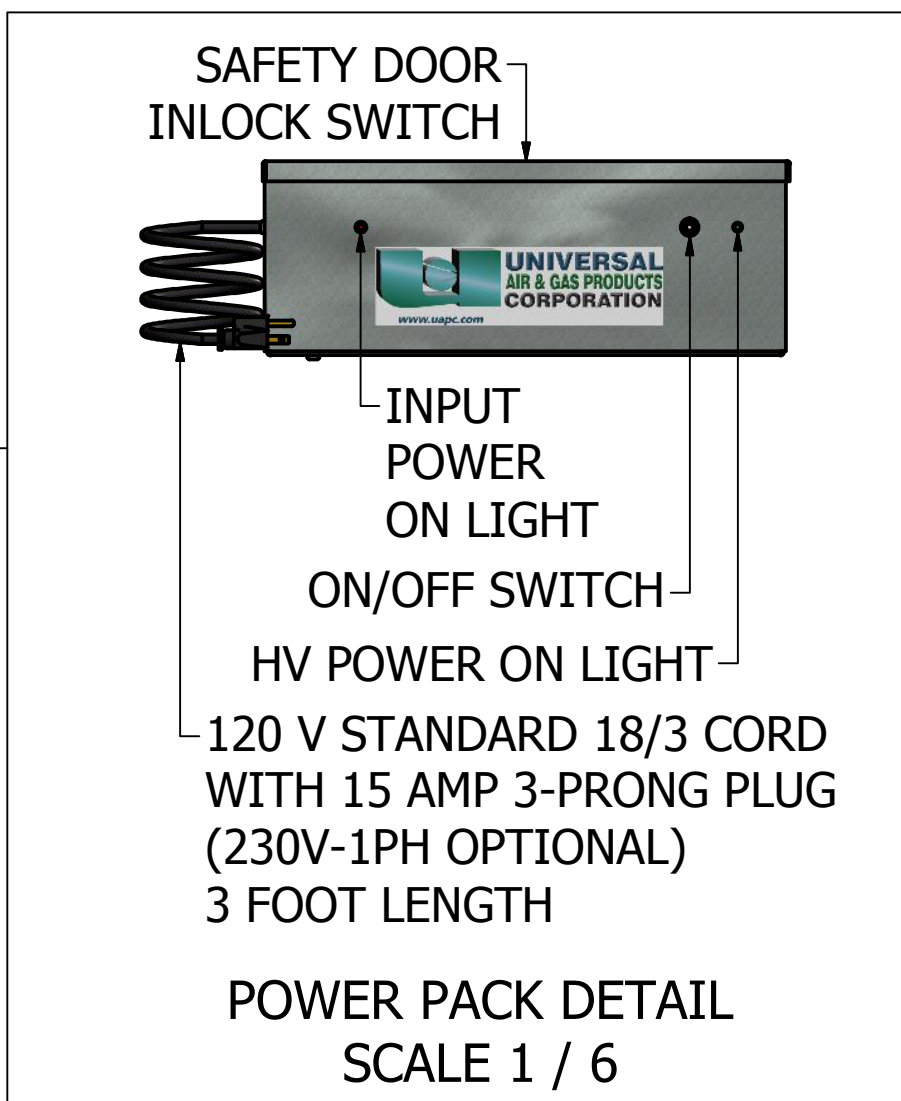

NOTE: REMOTE POWER PACK PROVISIONS  
AVAILABLE AS AN OPTION.

COMPANY  
CONFIDENTIAL

This drawing and all information herein is the  
property of Universal Air Products Corp. It is  
confidential and must not be made public or  
copied. It is loaned, subject to return upon  
demand. It is not to be used directly or  
indirectly in any way detrimental to the interests  
of UNIVERSAL AIR PRODUCTS.

LOCATION OF WATERWASH  
MANIFOLDS DEPENDS ON  
DIRECTION OF AIR FLOW

Ø1 INLET TUBES

LEGS (OPTIONAL)

STANDARD  
AIR FLOW

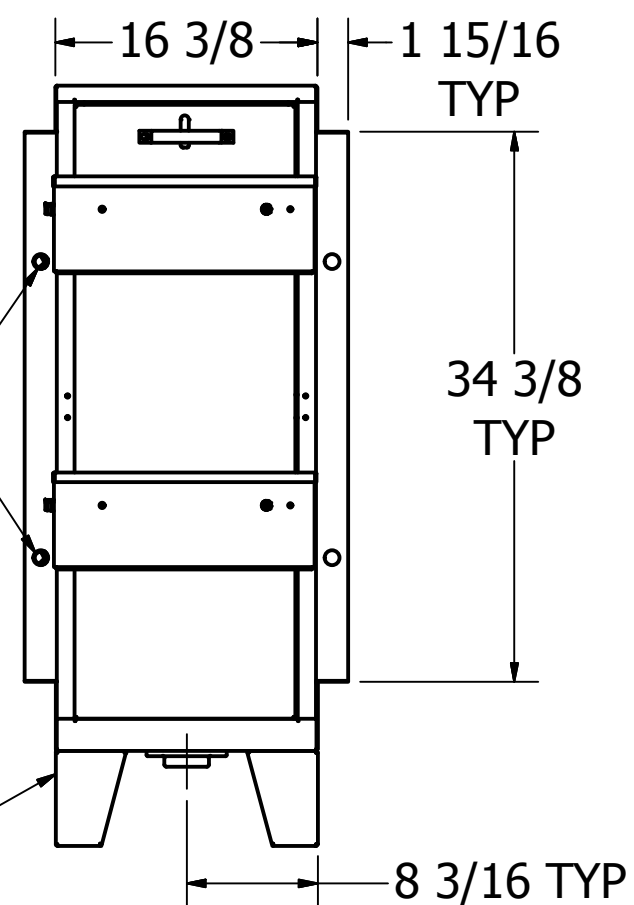
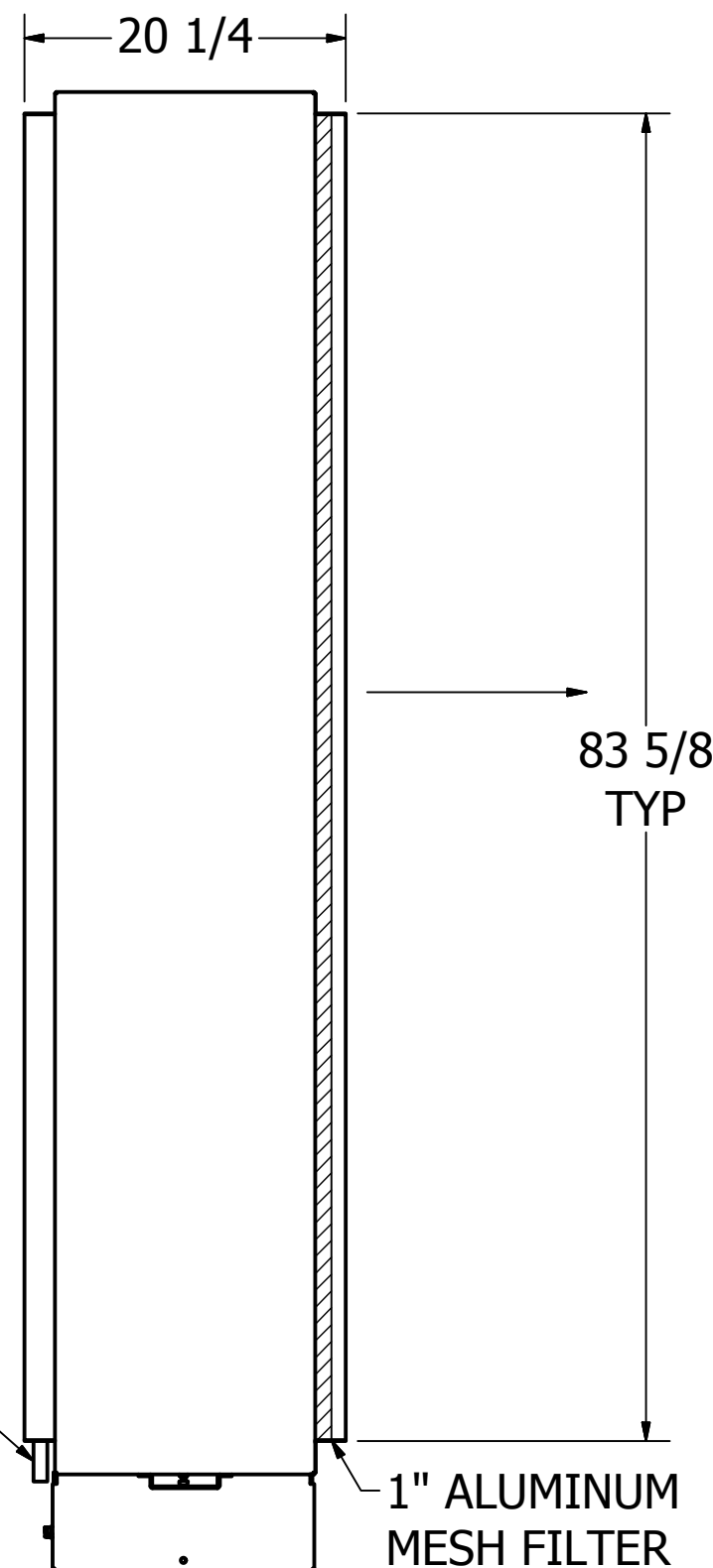

DRAWN KEF	6/27/2014	UNIVERSAL AIR & GAS PRODUCTS CORP. 1140 KINGWOOD AVE NORFOLK, VA 23502		
CHECKED		TITLE		
QA		C3-80H2: 8000 CFM COMMERCIAL 2 HIGH i3-80H2: 8000 CFM INDUSTRIAL 2 HIGH		
MFG				
APPROVED				
		SIZE C	DWG NO 3-80H2	REV B
		SCALE 1/12	SHEET 1 OF 1	